



SANSHING

TOTAL SOLUTION
THE ART OF TOOLING MANUFACTURE



Tooling Brochure



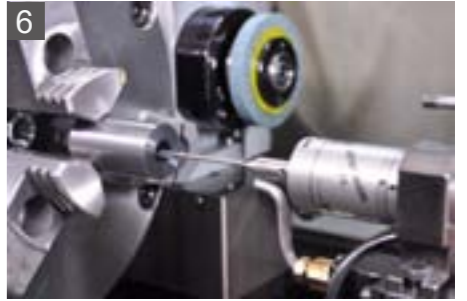

ABOUT SAN SHING TOOLING DIVISION

" SAN SHING FASTECH CORP." have accumulated more than 50 years' experience and techniques on the tooling manufacture. In addition to satisfy our own demands for the production of 80,000 tons of nuts annually, we also devoted half of our tooling production capacity in supplying domestic and global market. We always believe that to achieve customer satisfaction will surely facilitate our own growth.

STATE OF THE ART EQUIPMENT & WELL-ORGANIZED MANAGEMENT

Our tooling plants have more than 360 machines :

- 1. Stock room for raw materials
- 2. CNC machine : Turning process
- 3. Machining center
- 4. Multi tasking
- 5. Polishing
- 6. Internal grinding
- 7. SEIBU Wire cutting EDM
- 8. CAM / CAD / VISI3D drawing /Inventor 3D
- 9. Automation intergrated production line
- 10. Extrude hone processing
- 11. Profile grinding
- 12. EDM drilling
- 13. Heat treatment equipment
- 14. Engraving machine
- 15. Surface grinding
- 16. AGIE CHARMILLES EDM

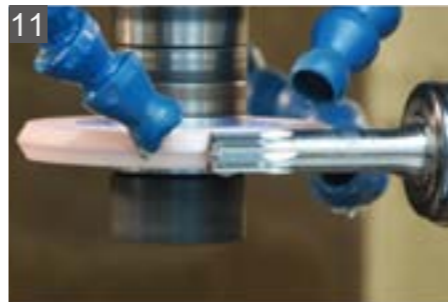

Carbide Tip Punch

| SS-9001 |



Advantage

- All carbide tip punches are well polished to increase punch service life.
- With advanced technique for welding SKD11 and carbide together, San Shing carbide tip punch is more economical and higher in wear-resistance compare to steel punch.
- All carbide tip punches are tested for tensile strength.
- ϕA Range: $\phi 6 \sim \phi 28$

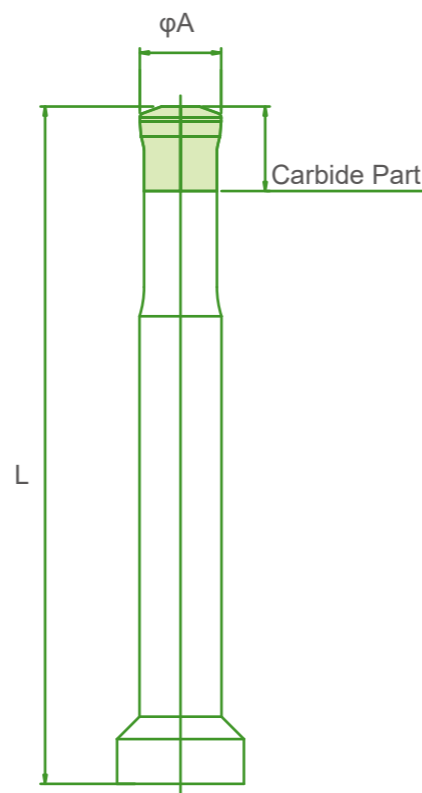

Carbide Hex Punch

Advantage

- The life span of carbide punch is 10 times higher than HSS punch. For example M6 Screw, wire coil SCM435, the average life span is 1.5 million pcs / per carbide punch (figure from San Shing)
- Carbide hex punch works well with heat treatment stainless steel.
- One-process production which increases tooling life and wear resistance.



| SS-2001 |

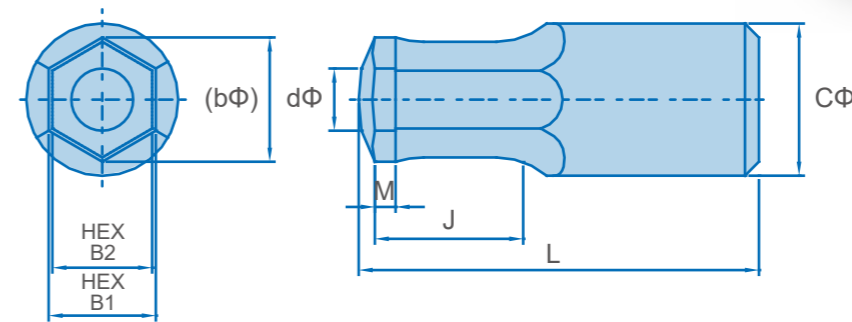

| SS-2003 |

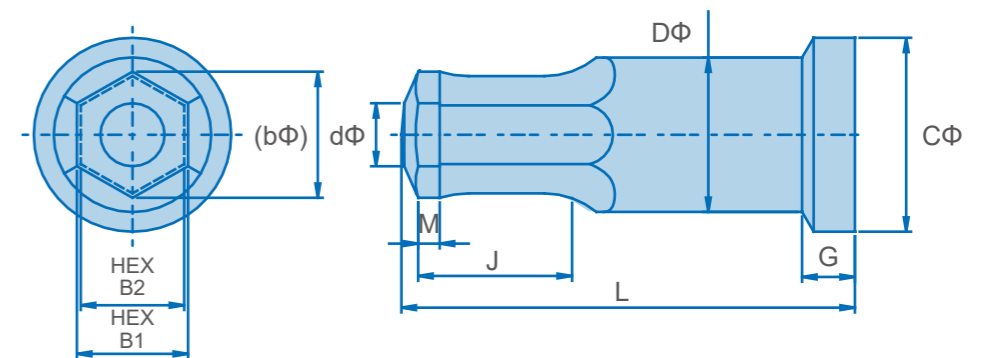

Segmented Die with Sleeve

| SS-600X |

With excellent lapping, the roughness could be achieved to **Ra 0.03** to enhance the life span.



| Advantage

- Wire cutting process that ensures higher tooling precision.
- Segment shape to enhance precision and fine polishing of die core.
- Oil vent design to enhance strength and makes it easier for die core replacement.

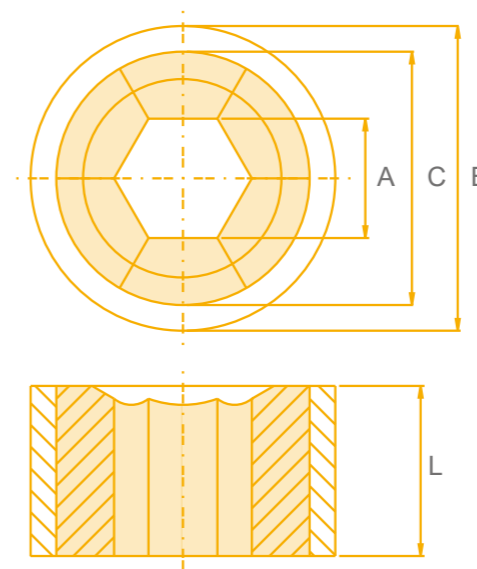

| SS-6001 |

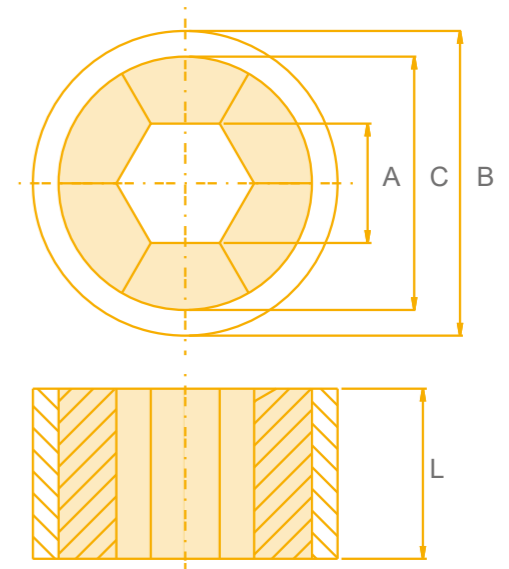

| SS-6000 |



50+ YEARS EXPERIENCES
IN TOOLING
MANUFACTURING



SEND INQUIRIES TODAY
WHERE YOUR DEMAND
CAN BE MET



Carbide Six Lobe Punch

| SS-1001 |

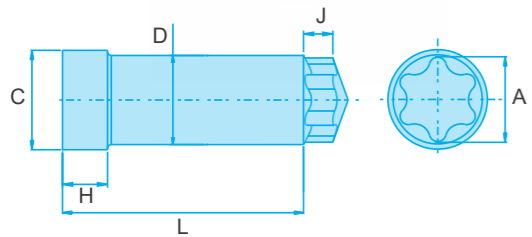

- Advantage**
- The tooling precision and quality are perfectly maintained which helps to reduce down time in tooling changeover.
 - We process various shapes of tooling as per customer's drawing.
 - Tool surface has been well polished and covered with fine coating, the tool precision could be well maintained.
 - Excellent tooling life brings more additional values for customers.
 - Size Range: T10~T50

| SS-1002 |

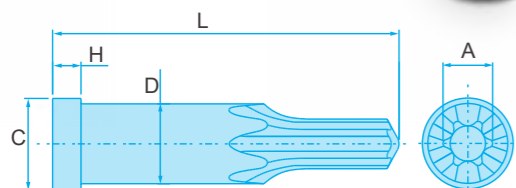

Excellent life span

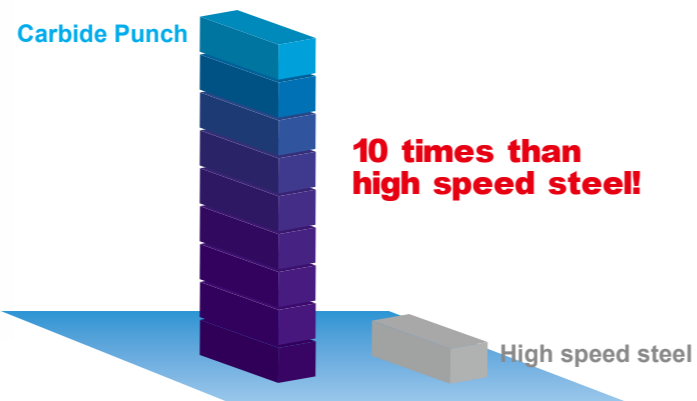

Carbide Six-Lobe Die

| SS-7001 |



- Advantage**
- Superior processing technology allows us to control tooling precision in the highest level.
 - Specially developed polishing technique for die core significantly enhances the wear resistance of tooling.
 - Size Range: E4~E44

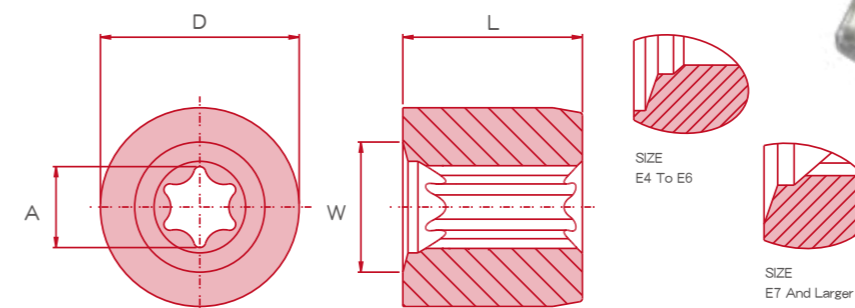
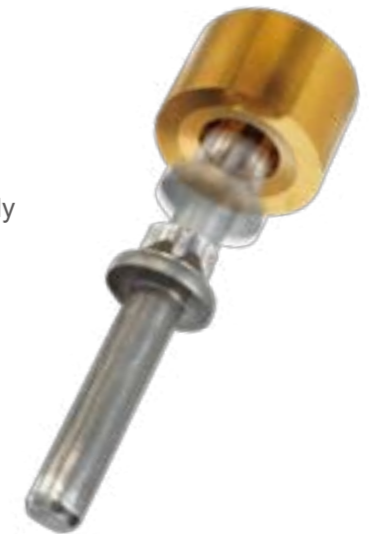

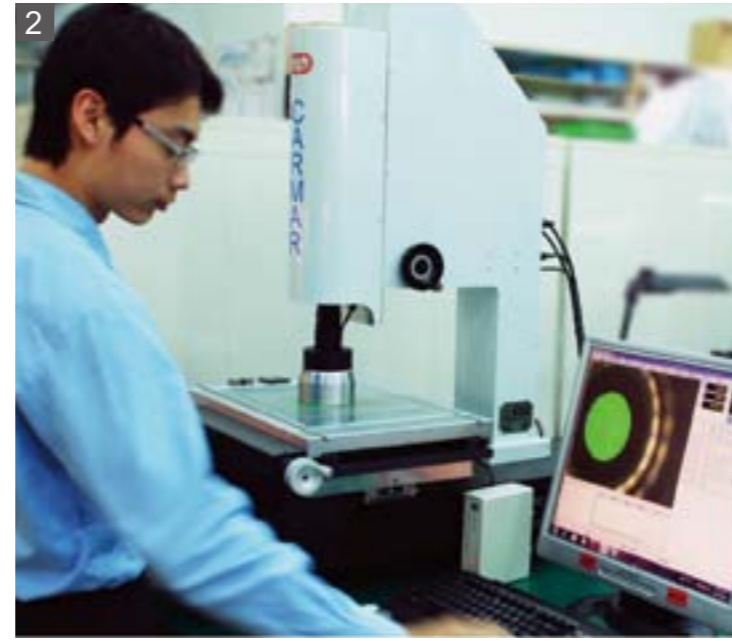

PRODUCTION MANAGEMENT & QUALITY ASSURANCE

San Shing is honored with many quality certifications such as ISO 9001, ISO14001, and OHSAS 18001. Our products are recognized worldwide. Especially, our surface finish is maintained within 0.02 micron, well up to the American and European standards.

1. 3D Coordinate measuring machine
2. Profile projector 2.5D
3. Automatic punch measurement system
4. Digimatic height gage
5. Profile projector
6. Contour tracer & surface roughness measurement
7. Customer service on-line system
8. Rockwell hardness tester
9. Laser etching & engraving
10. Bar code process control system
11. Inspection report
12. Foam-In-Bag packaging system

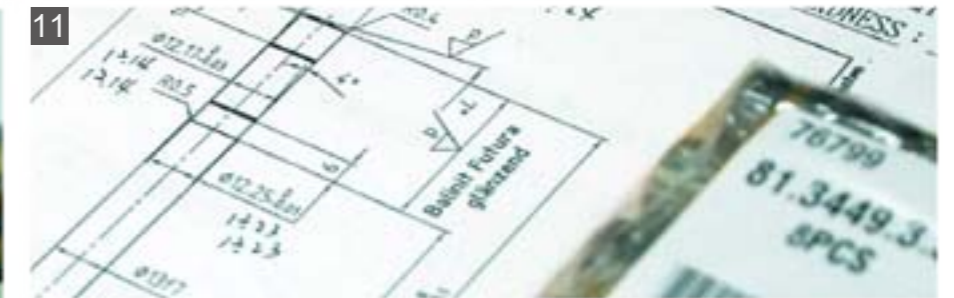
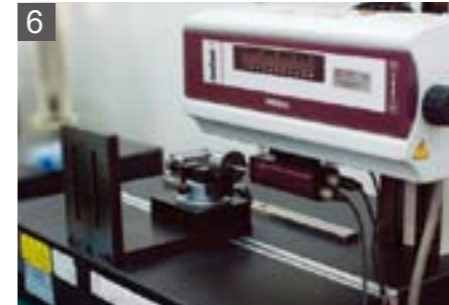

We are confident that our strict inspection control and computerized production processes can provide our customers with high quality, cost-effective tooling and flexible delivery schedules.



WORKING HARD TO BE THE BEST
STRATEGIC PARTNER FOR OUR
CUSTOMERS

At SAN SHING, we believe our vertically integrated production, focus on innovation and quality, and professional work force create the highest quality products and top service in the business. That's why we're the best partner for our customers.

WE WOULD LIKE TO TAKE THIS OPPORTUNITY TO THANK YOU FOR YOUR SUPPORT.



SAN SHING FASTECH CORP.

No.355, Chung Shan Road , Section 3,
Gui-Jen , Tainan , Taiwan
Tel :+886-6-230-9949
Fax:+886-6-330-3415
E-mail:machine.tool@mail.sanshing.com.tw
www.sanshing.com.tw

